

Technical Instructions -SPX Signia Carbon









Glazing I SPX Signia Carbon

Frame is made with 5.0 base curve. Other base curves can be used and will require bridge adjustment for proper lens alignment.

Use Silhouette mounting plier with purple fitting and BLS 58/98/97 sleeves for glazing.



BLS 58 STANDARD	BLS 98 „long“	BLS 97 „short“
Standard Glazing 	for very thick lenses 	for very thin lenses 
Lens size 2,0 - 6,5 mm	6 - 9,5 mm	1,3 - 3 mm
		
1,4 mm	1,4 mm	1,4 mm

Inclination | SPX Signia Carbon



1. Open temple fully.
2. Hold lens fixation firmly with mounting pliers.



3. Grasp temple edge firmly and adjust inclination of end piece into required position.

Adjust temple opening | SPX Signia Carbon

Reduce

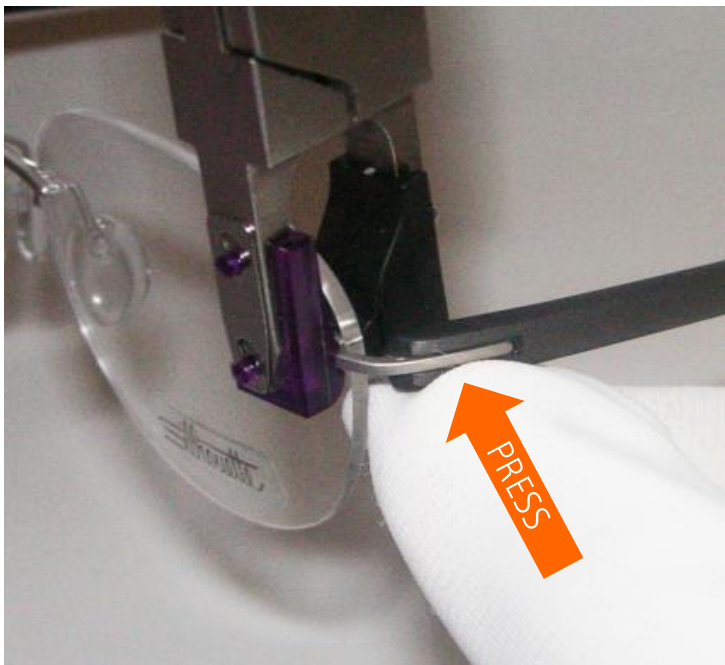

Enlarge



Temple assembly | SPX Signia Carbon



- Position titanium end piece at temple.
- Cover edge of table or bench with cloth to protect end piece.
- Press temple into titanium end piece.

Temple adjustment | SPX Signia Carbon

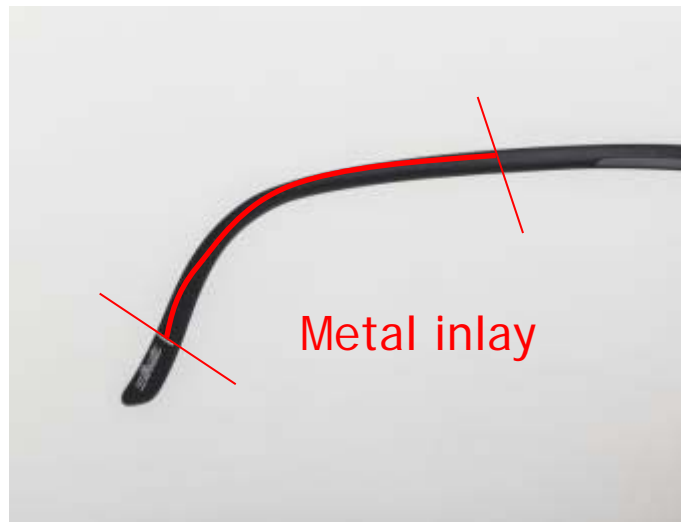

Adjustment without heating is possible due to metal inlay surrounded by SPX. Do not bend the temple in areas without the metal inlay.

Silhouette®

AUTHENTIC EYEWEAR. SINCE 1964.