

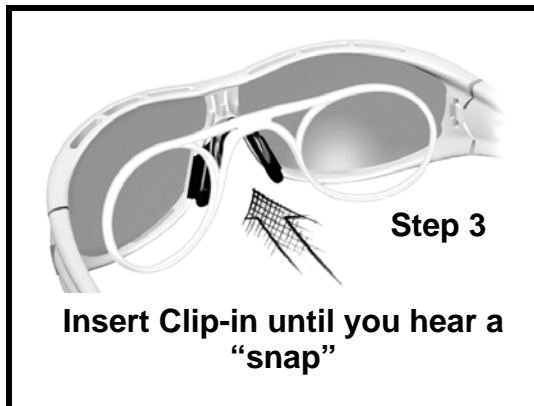

Using the a731 and a727 Insert or Clip-in

a731 and a727 clip-ins have a small black pin in the hole. This design is to maintain the hole integrity during the glazing process. These clip-ins like all SPX product should be glazed cold. The **first step** is to remove the black pin. **Second step** is to remove the plastic part covering the groove/pin on the sunglass that the clip-in attaches to. The **third step** is to attach clip-in with a “snap”. Use reasonable force, only when the parts are aligned correctly.

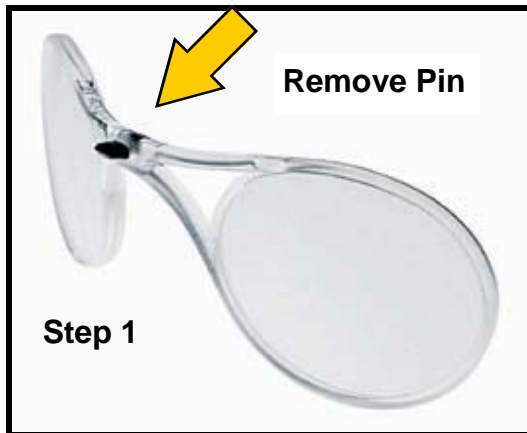

Styles: a123, a124, a125, a129, a132

Remove the V shaped plastic piece on the inside of the sunglass above the bridge

a126, a127, a134, a135, a266, and a267

Nothing to remove from inside of the sunglass

a136 elevation ClimaCool

Remove the V shaped plastic piece on the inside of the sunglass above bridge

Call 866-315-1929 for further assistance